

# **OLC Adventure**

## **Dachzelt OLC130 / 145 Ultra Light**

### **Installationsanleitung**

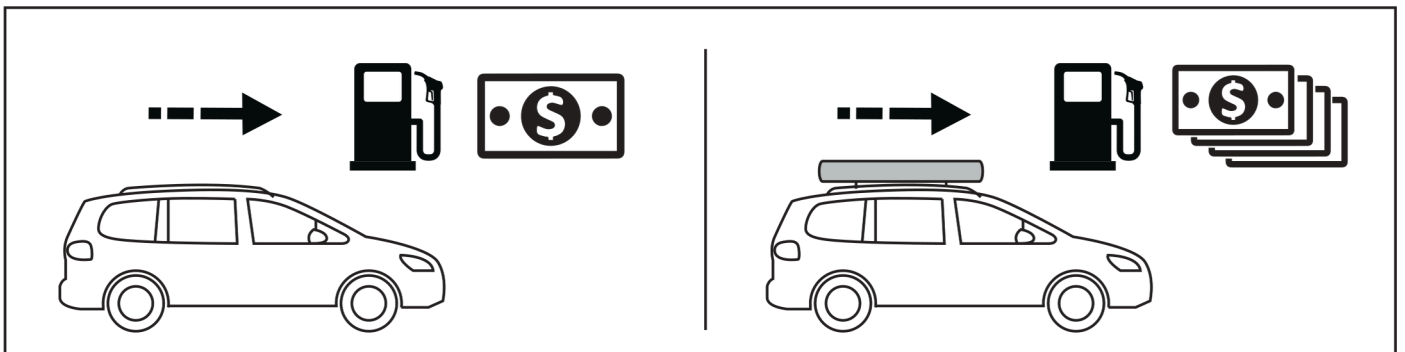

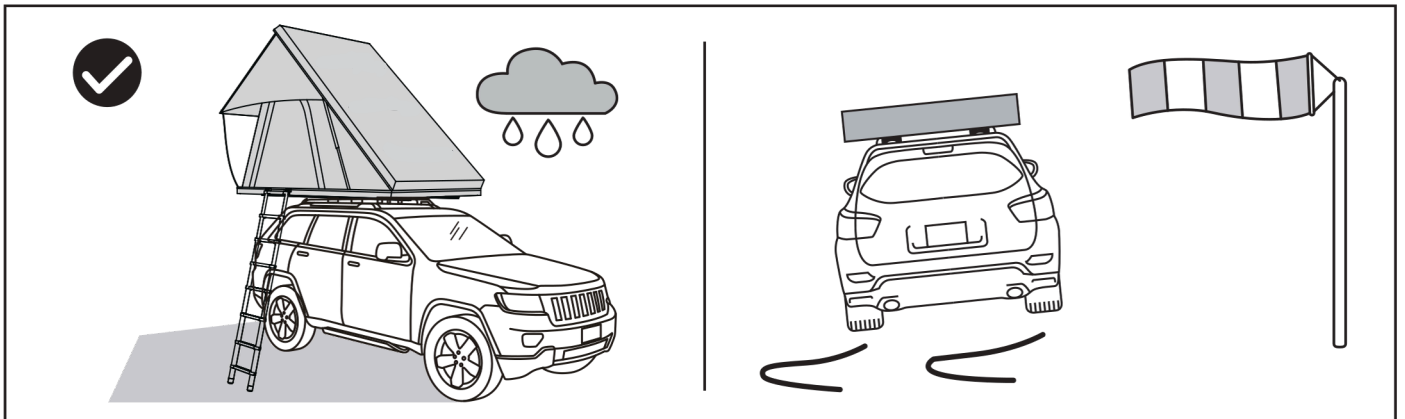
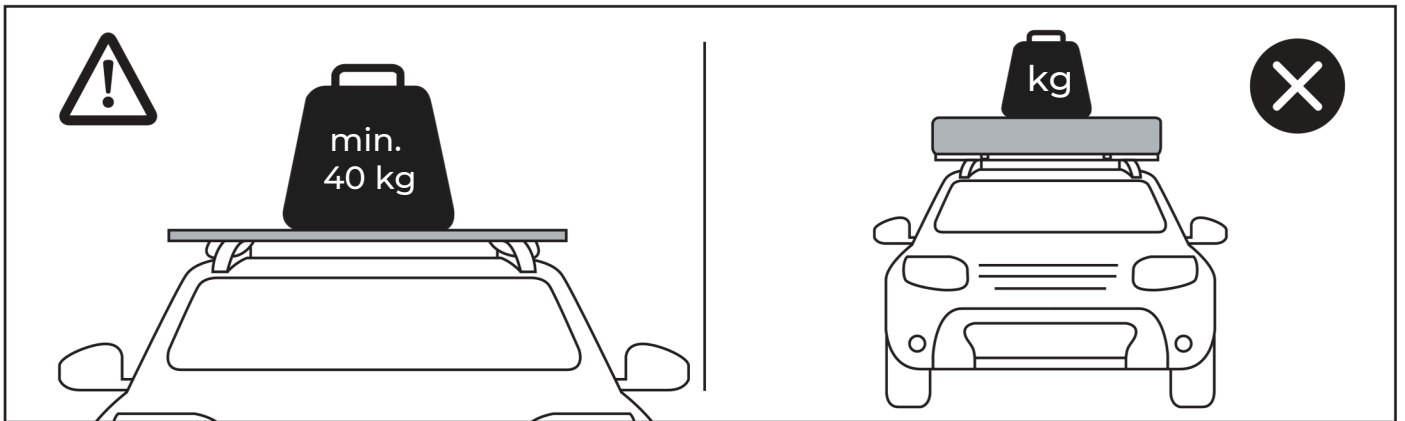
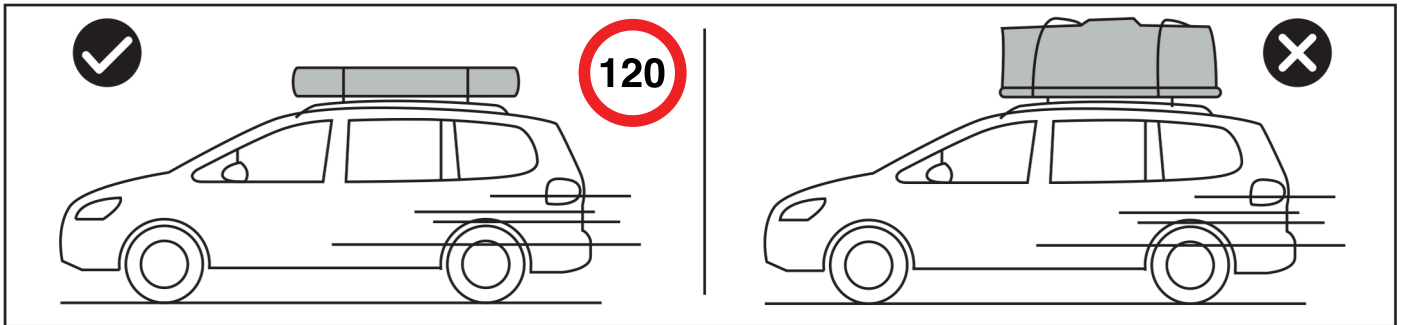
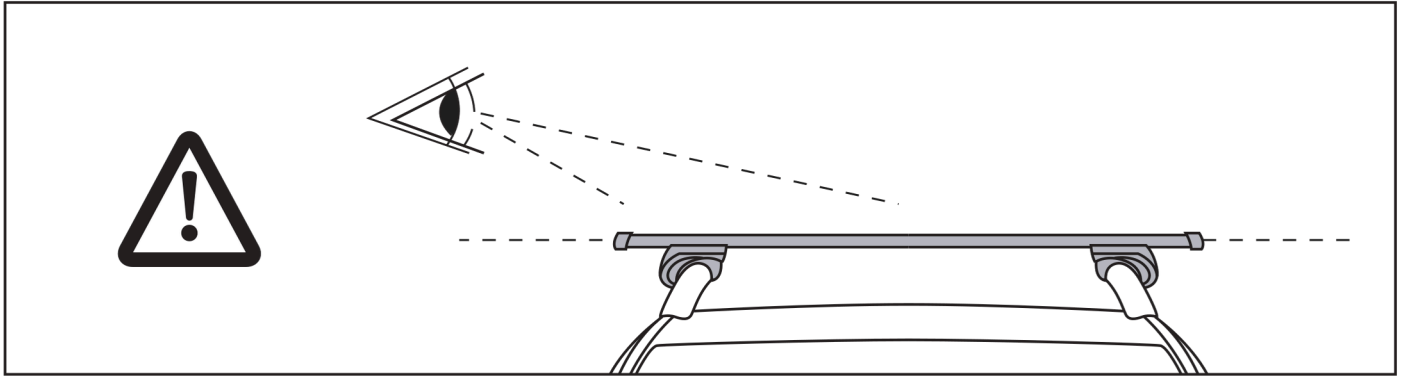

**A** x2



**B** x2



**C** x4



**D** x6

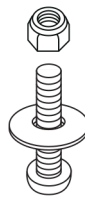

**E** x8

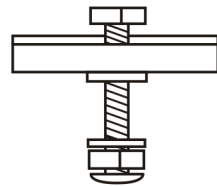

**F** x2

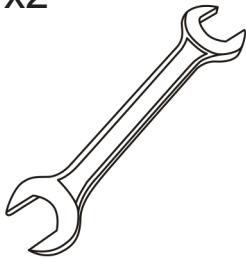

**G** x1

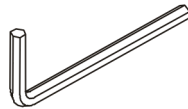

**H** x4

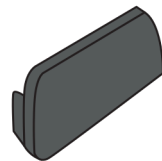

**I** x1

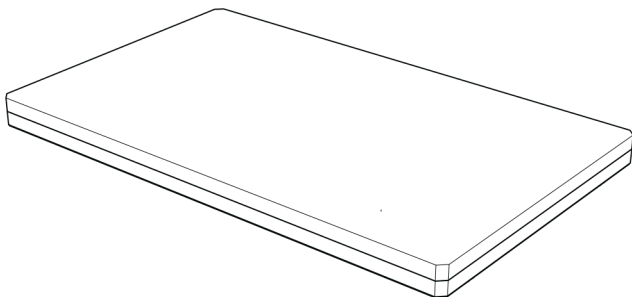

**L** x1

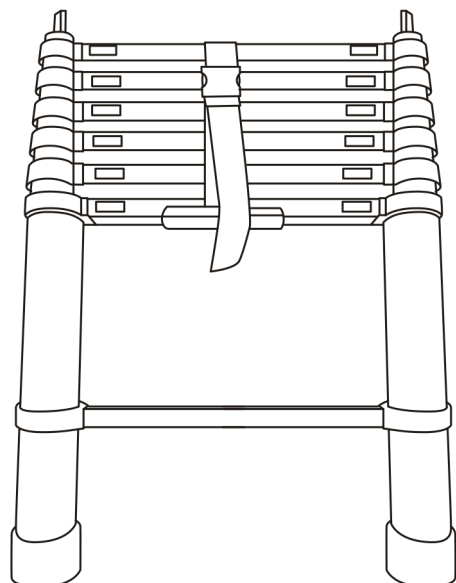

## ① Trägerschienen montieren

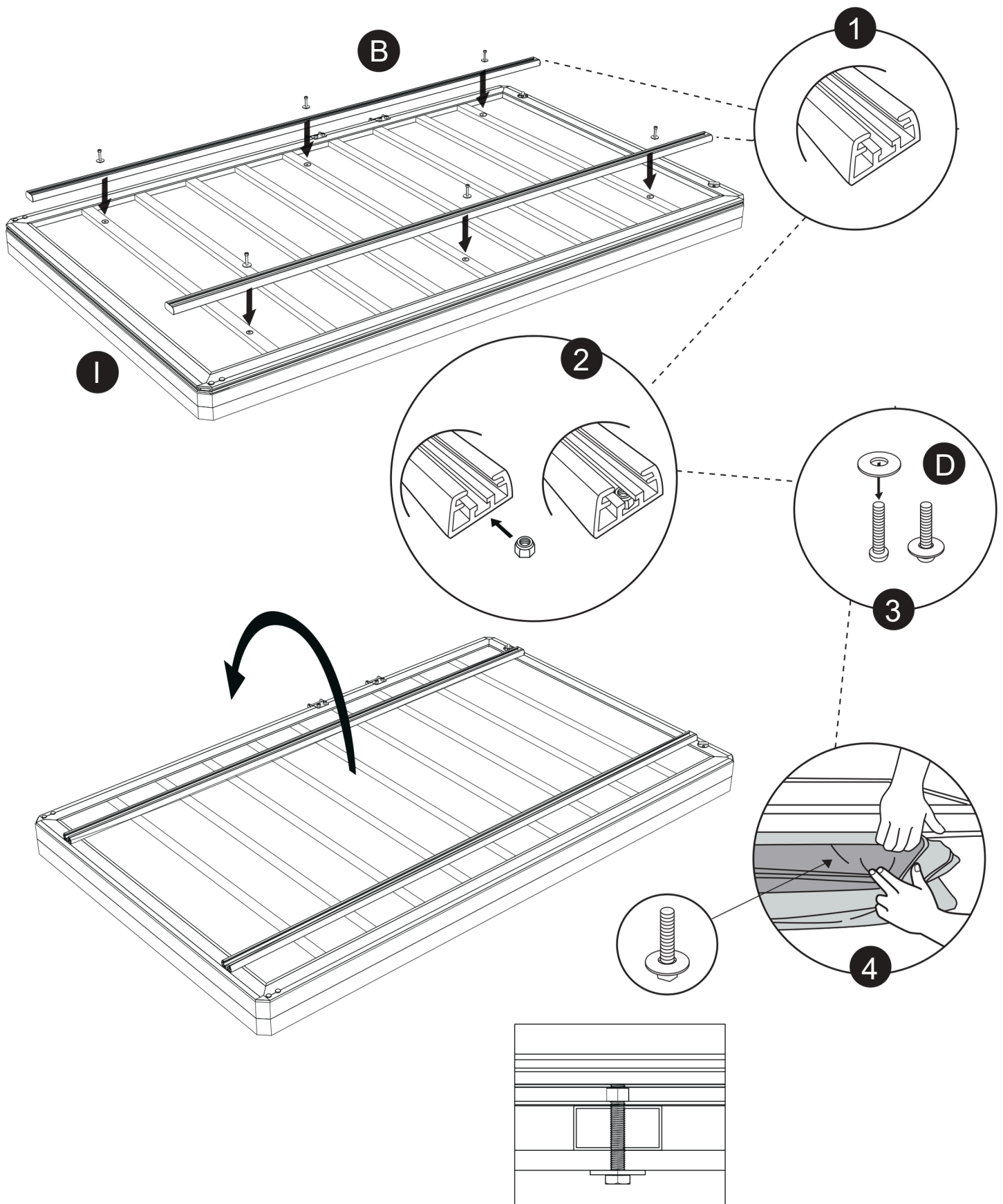

## ② Dachzelt auf den Querträgern des Fahrzeugs montieren

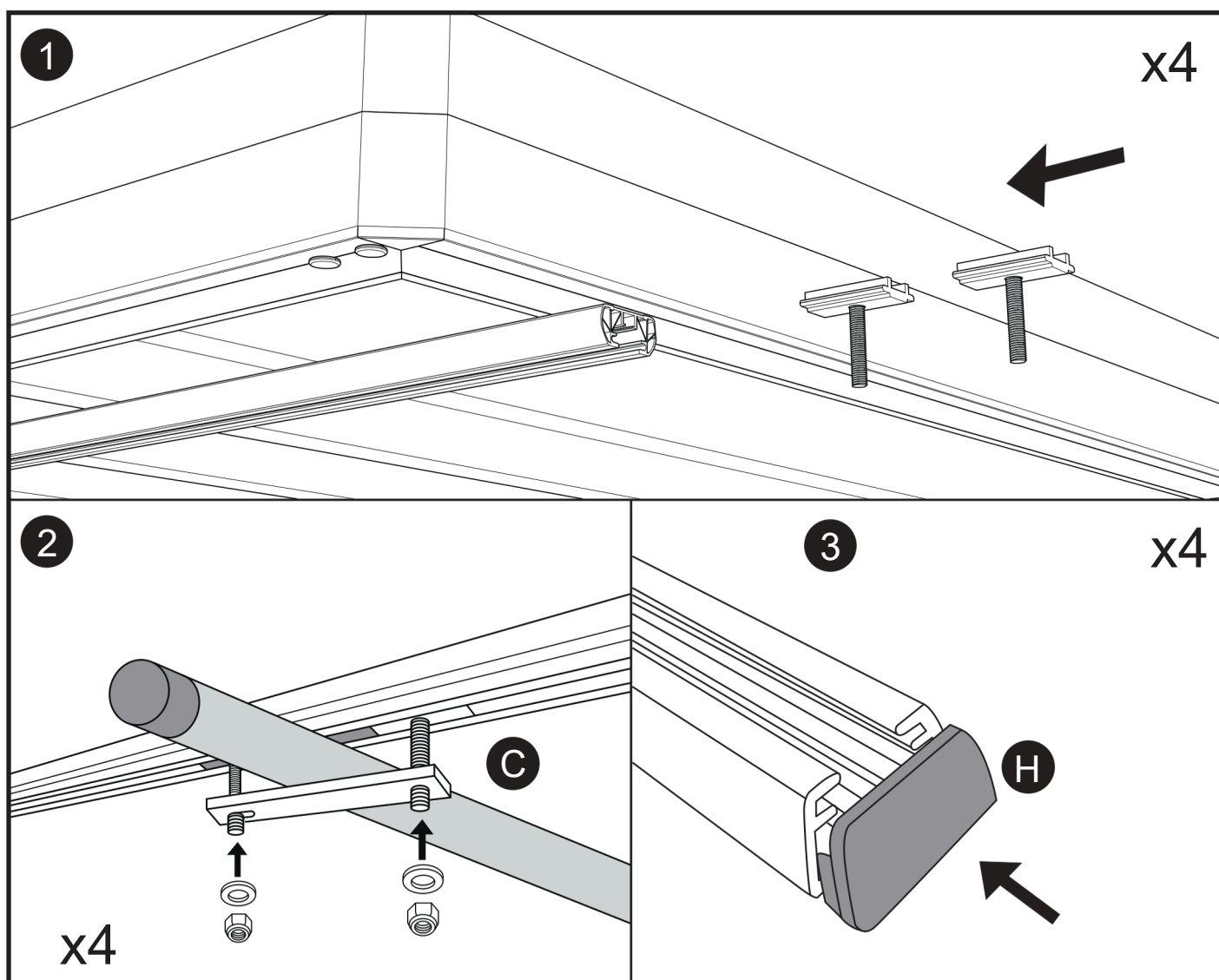
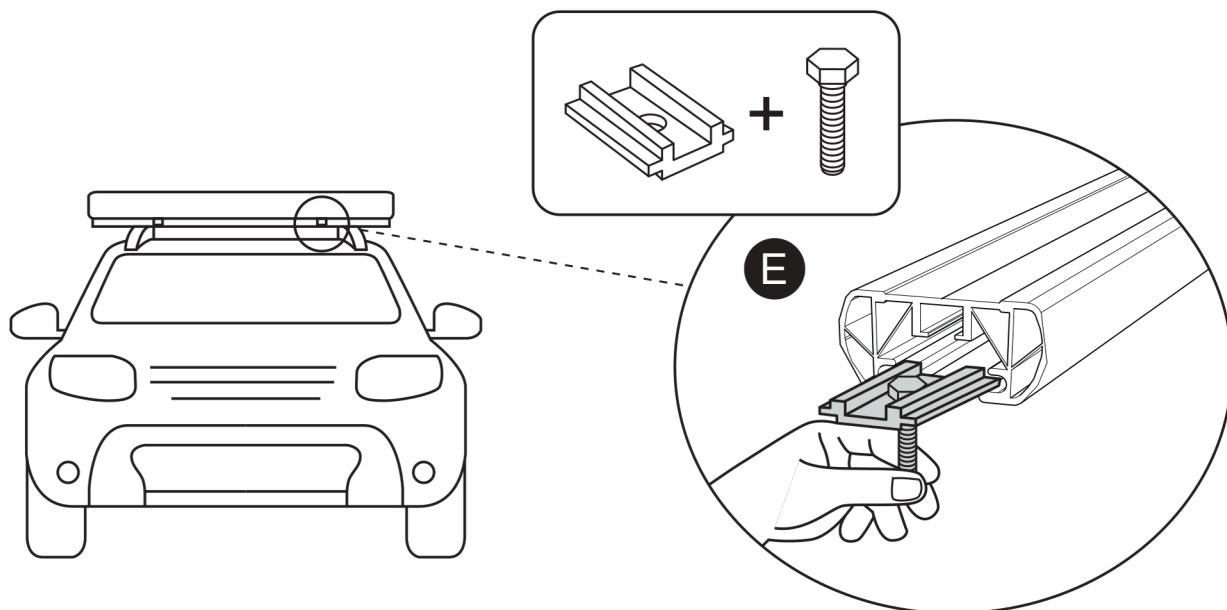

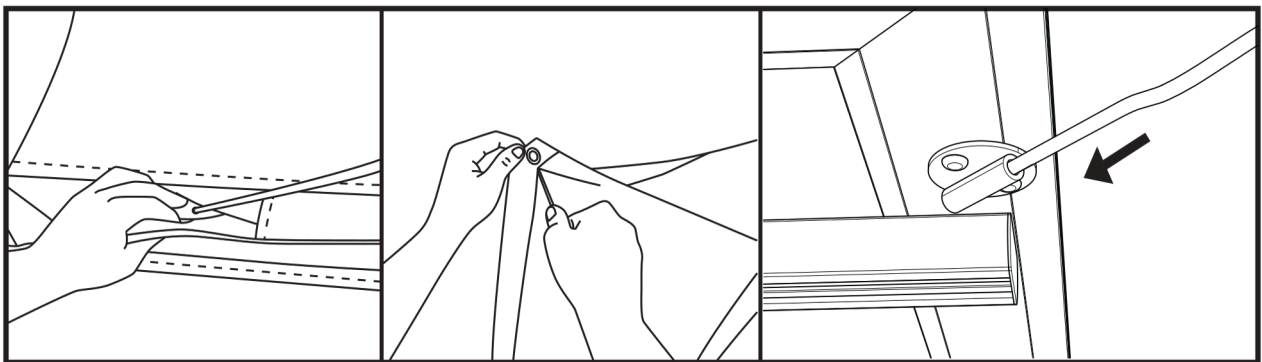
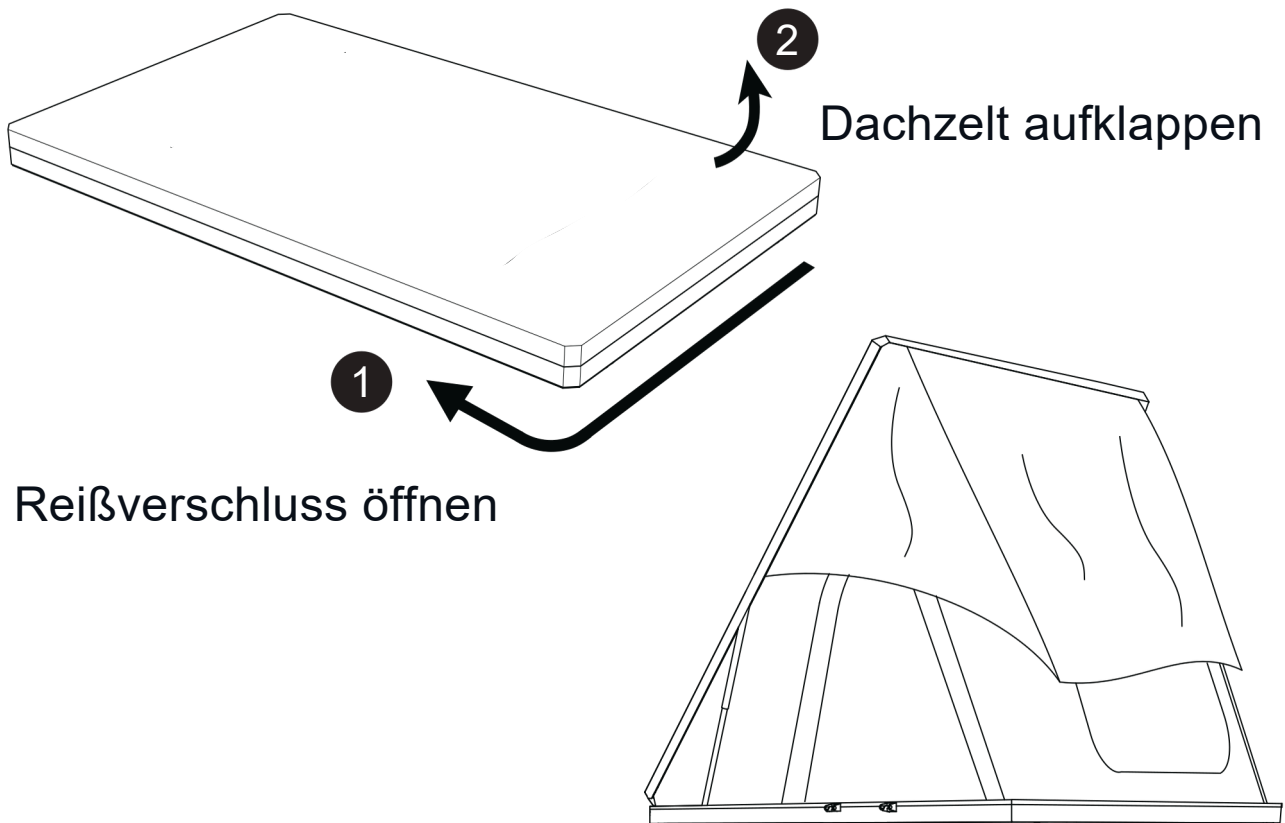

Beide Aufstellstangen zuerst unten am Dachzelt in die Aufnahmen stecken, dann in die Ringösen der Fly einhängen

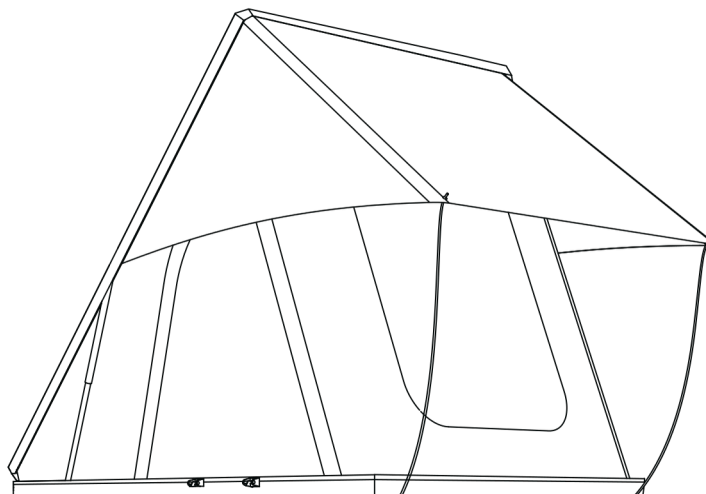



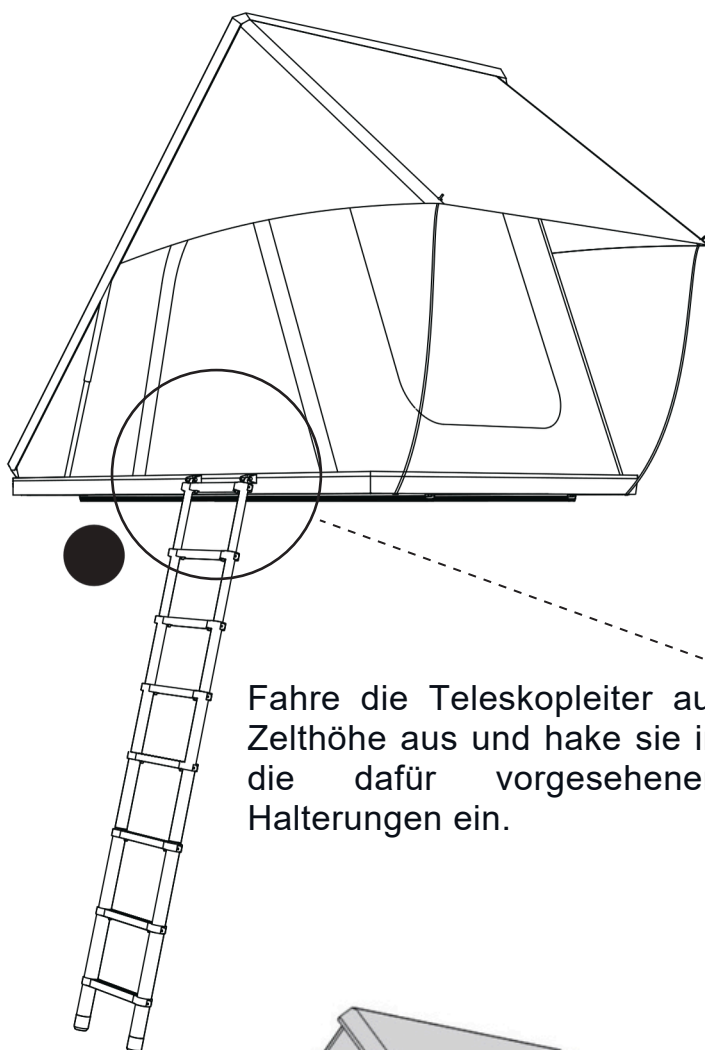

Fahre die Teleskopleiter auf Zelthöhe aus und hake sie in die dafür vorgesehenen Halterungen ein.

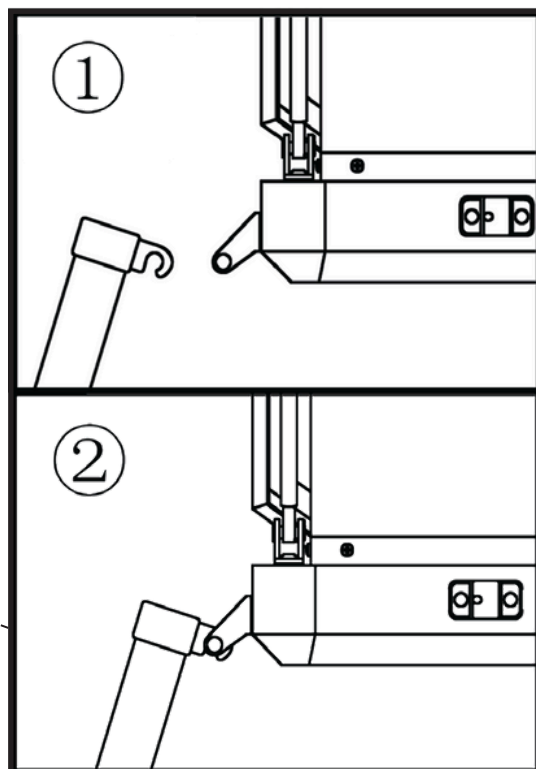

## WICHTIG

Stelle sicher, dass beim Schließen des Reißverschlusses kein Zeltstoff aus dem Dachzelt ragt.



# Notizen